

# 1 Cylinder head complete RV K2.0X

Home and Garden \ High pressure cleaner cold water \ Electric motor \ K 3 \ K 3 Power Control \*EU \ Pump cpl. KP 2/0-N-UM\*EU \ KP -2/0-N-UM\*EU-220-240/50-60-5,5/8+INA \ Cylinder head for replacement (981) RV \ Cylinder head

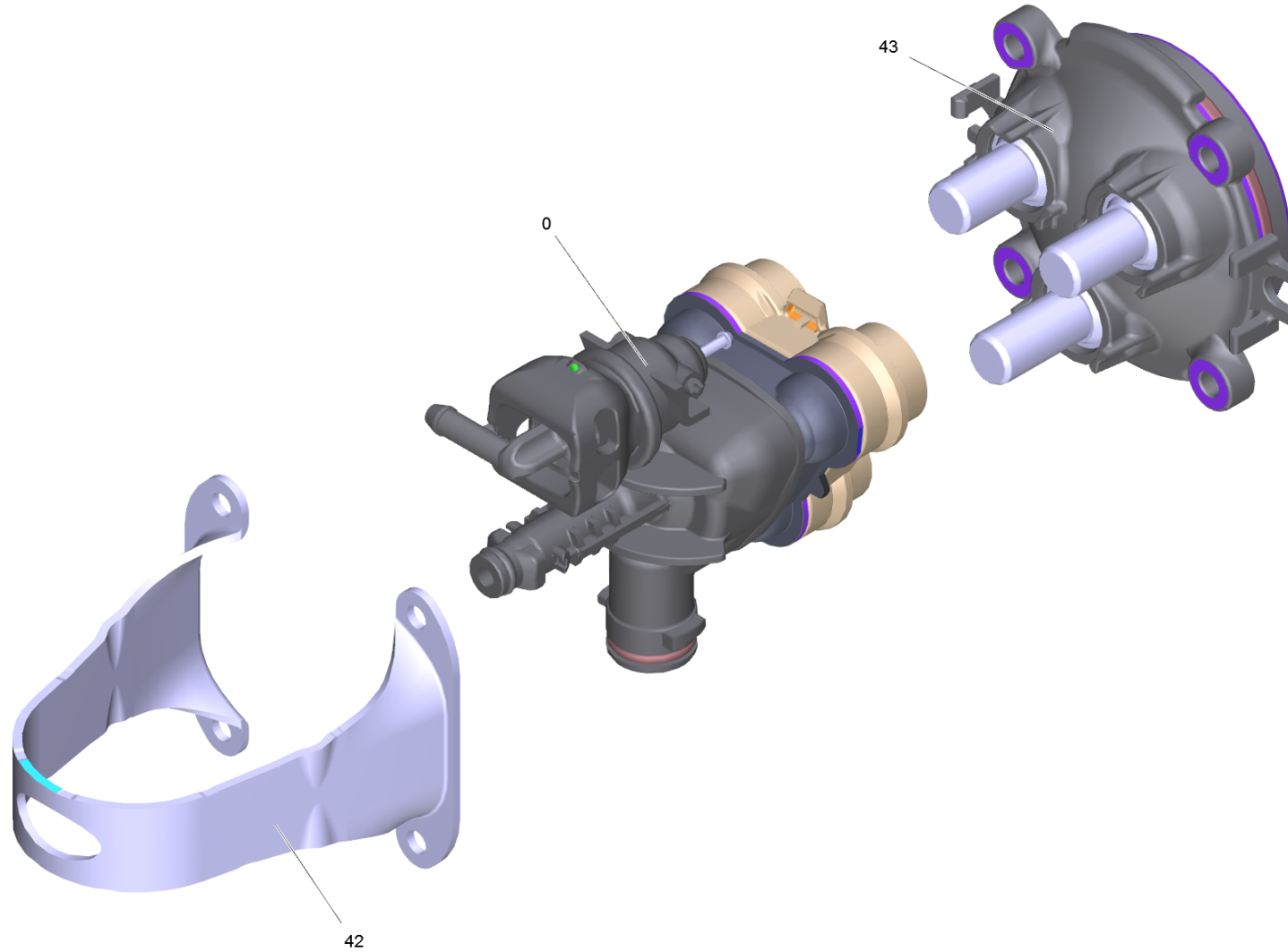

# 1 Cylinder head complete RV K2.0X

Home and Garden \ High pressure cleaner cold water \ Electric motor \ K 3 \ K 3 Power Control \*EU \ Pump cpl. KP 2/0-N-UM\*EU \ KP -2/0-N-UM\*EU-220-240/50-60-5,5/8+INA \ Cylinder head for replacement (981) RV \ Cylinder he



| POS | Article no. | Description                        | Quantity | Unit |
|-----|-------------|------------------------------------|----------|------|
| 0   | 4.551-159.3 | Cylinder head only for replacement | 1        | PC   |
| 42  | 5.051-384.0 | Sheet metal component 4-fach       | 1        | PC   |
| 43  |             | Thrust guidance complete quadruple | 1        | PC   |